



# SAMPLE REQUEST FORM

Thank you for your interest in the **Best Pin™ Ceramic Coated Weld Pin**.  
 We offer free samples of standard sizes, including M06, M08 and M10 (see below).  
 To request a sample, please complete the information below and submit it to  
 G.E. Schmidt, Inc. via email ([sales@geschmidt.com](mailto:sales@geschmidt.com)) or fax ([513]-489-5132).

**G.E. Schmidt, Inc.**  
 11236 Williamson Rd.  
 Cincinnati, OH 45241  
[sales@geschmidt.com](mailto:sales@geschmidt.com)  
**Phone: (513) 489-5130**  
**Fax: (513) 489-5132**

<b>CONTACT &amp; COMPANY INFO</b>	NAME	COMPANY
	TITLE	MAILING ADDRESS
	EMAIL ADDRESS	
	PHONE & EXT.	PRIMARY INDUSTRY
<b>COMPANY ACTIVITIES:</b> (Check all that apply.)		
<input type="checkbox"/> Projection (Nut/Stud) Welding		
<input type="checkbox"/> Spot Welding		
<input type="checkbox"/> Seam Welding		
<input type="checkbox"/> Flash Welding		
<input type="checkbox"/> CD Stud Welding		
<input type="checkbox"/> Cross-Wire Welding		
<input type="checkbox"/> Butt Welding		
<input type="checkbox"/> Nut/Bolt Feeding		
<input type="checkbox"/> Tip Dressing		
<input type="checkbox"/> Quality Testing		
<input type="checkbox"/> Robotic Applications		
<input type="checkbox"/> MIG/TIG Welding		
<input type="checkbox"/> _____		

**BEST PIN™ REQUEST**

M06 Best Pin™  
 M08 Best Pin™  
 M10 Best Pin™  
 OTHER\*: \_\_\_\_\_

**M06 Weld Pin**

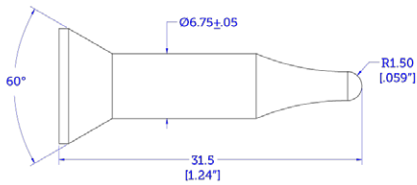

**M08 Weld Pin**

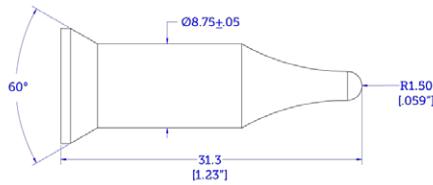

**M10 Weld Pin**

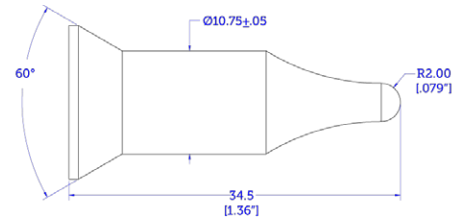

## HOW ELSE CAN WE HELP?

G.E. Schmidt, Inc. is a full-service provider for the resistance welding industry. In addition to consumables, GES specializes in nut welding quality control and feeding systems, as well as a broad range of components and accessories for nut and spot welding.

---



---



---



---

\* Other sizes or styles, such as M05 or dome nose pins, may be available, but are not guaranteed to be offered as samples due to cost and/or stock constraints.